

# **Nokia 2300 Variants**

[This page left intentionally blank]

Table of Contents

	Page No
General information about Nokia RM-4/5 .....	5
Nokia 2300 exploded diagram .....	5
Assembly parts for Nokia 2300 .....	6
Mechanical parts .....	6
Variant parts .....	7
Swap units .....	8
Basic transceiver Nokia 2300 and variants .....	9
Nokia 2300 Eur/Afr/APAC .....	9
Nokia 2300 CN .....	9

[This page left intentionally blank]

## General information about Nokia RM-4/5

Nokia RM-4/5 (Nokia 2300) are based on a common phone platform with a b/w display. The Nokia 2300 operates on dual-band GSM (900/1800 MHz) networks.

The phone is delivered in several versions which are listed on the pages below.

### Nokia 2300 exploded diagram

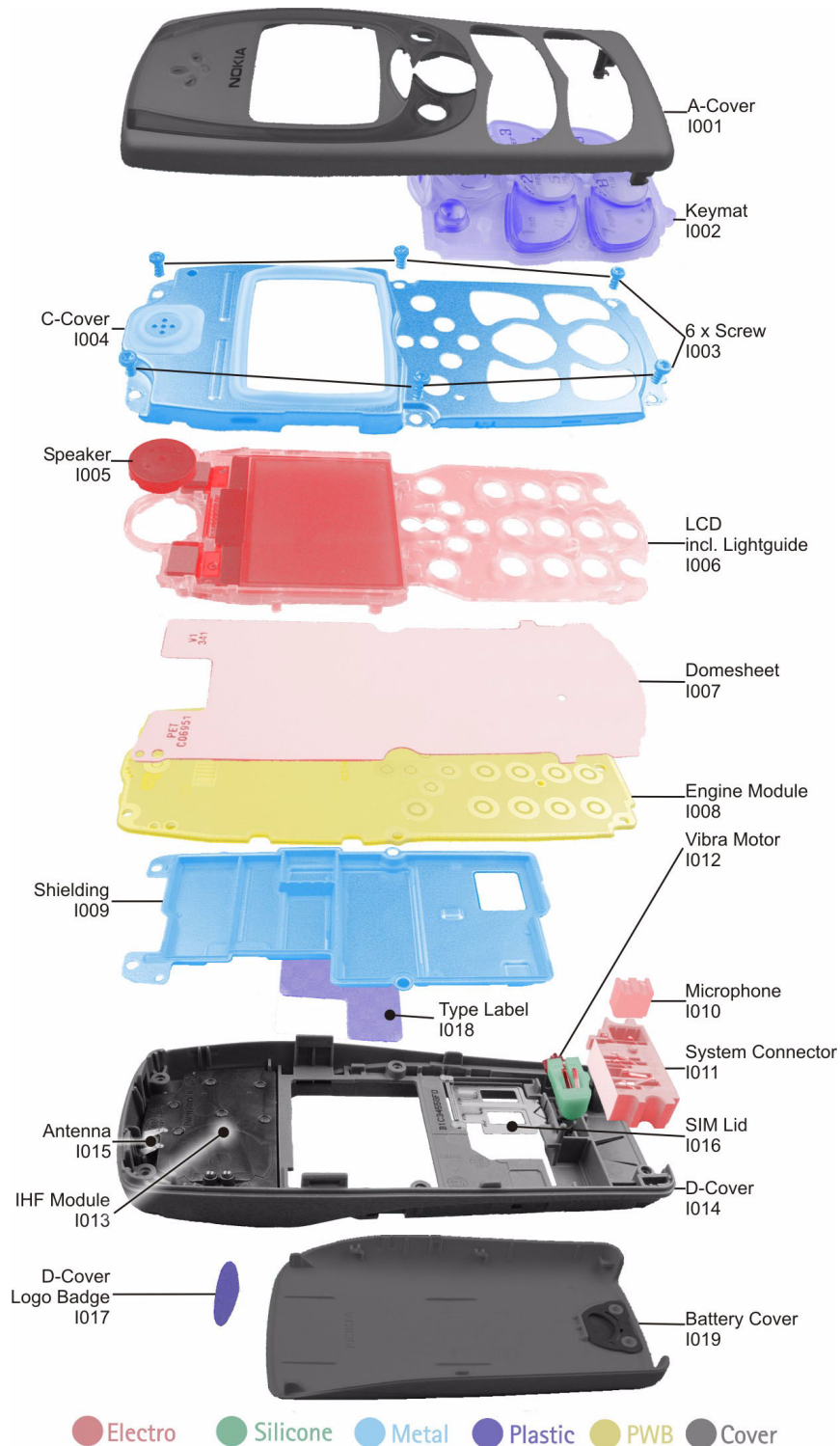

**Assembly parts for Nokia 2300**

**Mechanical parts**

ITEM/ CIRCUIT REF.	QTY	PART NO	PART NAME
I001	1	XXXXXXX	A-COVER SUB ASSY
I002	1	XXXXXXX	KEYMAT
I003	6	6290083	SCREW 1.8X5.3 T6+
	1	485M068	DISPLAY ASSY
I004	1	-	C-COVER
I005	1	5140233	SPEAKER
I006	1	-	LCD INCL. LIGHTGUIDE
I007	1	9795147	DOME SHEET
I008	1	-	ENGINE MODULE
I009	1	9517314	SHIELDING
I010	1	5140201	MICROPHONE
I011	1	5460119	SYSTEM CONNECTOR
I012	1	6800053	VIBRA MOTOR
	1	9492069	D-COVER ASSY
I013	1	-	IHF MODULE
I014	1	-	D-COVER
I015	1	-	ANTENNA
I016	1	-	SIM LID
I017	1	-	D-COVER LOGO BADGE
I018	1	9381382	TYPE LABEL
I019	1	XXXXXXX	BATTERY-COVER

## Variant parts

ITEM/ CIRCUIT REF.	QTY	PART NO	PART NAME
I001		9459290	A-COVER SUB ASSY - LIGHT GREY FEMME
I001		9491855	A-COVER SUB ASSY - GRAPHITE HOMME
I002		9791118	Keymat Femme - Latin
I002		9792001	Keymat Homme - Latin
I002		9792008	Keymat Femme - Cyrilic
I002		9792007	Keymat Homme - Cyrilic
I002		9792012	Keymat Femme - Hebrew
I002		9792011	Keymat Homme - Hebrew
I002		9792010	Keymat Femme - Greek
I002		9792006	Keymat Homme - Greek
I002		9792009	Keymat Femme - Arabic
I002		9792005	Keymat Homme - Arabic
I002		9792020	Keymat Femme - Farsi
I002		9792019	Keymat Homme - Farsi
I002		9792018	Keymat Femme - Urdu
I002		9792017	Keymat Homme - Urdu
I019		9470534	B-cover light grey Femme
I019		9491857	B-cover graphite Homme

Swap units

QTY	PART NAME	PART NAME
	0052062	RH-4 N2300 SWAP ENGINE EUROPE & AFRICA
	0052195	RH-4 N2300 SWAP ENGINE POLAND
	0052190	RH-4 N2300 SWAP ENGINE TURKEY
	0052189	RH-4 N2300 SWAP ENGINE FRANCE
	0052194	RH-4 N2300 SWAP ENGINE CZECH
	0052193	RH-4 N2300 SWAP ENGINE SOUTH AFRICA
	0052192	RH-4 N2300 SWAP ENGINE RUSSIA
	0052191	RH-4 N2300 SWAP ENGINE UKRAINE

C-cover assembly marking method



Tool number starting with

- “C” - China (Wintek)
- “K” - Korea (Samsung)

This marking is used to identify the LCD supplier. The information is requested when reporting the replaced parts.



**Basic transceiver Nokia 2300 and variants**

<b>Name</b>	<b>Type code</b>	<b>Material code/ module type</b>	<b>Module code</b>
Basic transceiver Nokia 2300	RM-4/RM-5		

**Nokia 2300 Eur/Afr/APAC**

Technical type RM-4 for Europe/Africa and APAC

<b>Name</b>	<b>Type code</b>	<b>Material code/ module type</b>	<b>Module code</b>
Basic transceiver Nokia 2300	RM-4		
Engine module		1fg	BOM1: 0202187 BOM2: 0202285
Mechanics assembly parts	RM-4		0263081

**Nokia 2300 CN**

Technical type RM-5 for China

<b>Name</b>	<b>Type code</b>	<b>Material code/ module type</b>	<b>Module code</b>
Basic transceiver Nokia 2300	RM-5		
Engine module		1fg	BOM1: 0202187 BOM2: 0202285
Mechanics assembly parts	RM-5		0263081

[This page left intentionally blank]